

Copyright: Copyright infringement reserved.

INOVANCE

A3

| Amendment | Description |
|-----------|-------------|
| | |

Unit: Millimeter (mm)

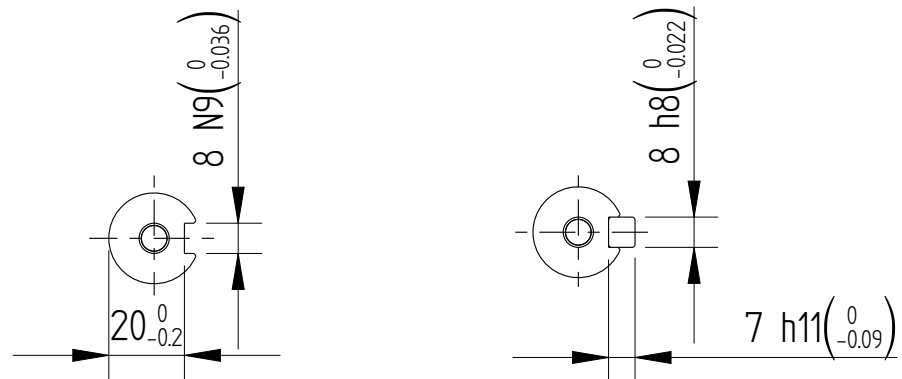
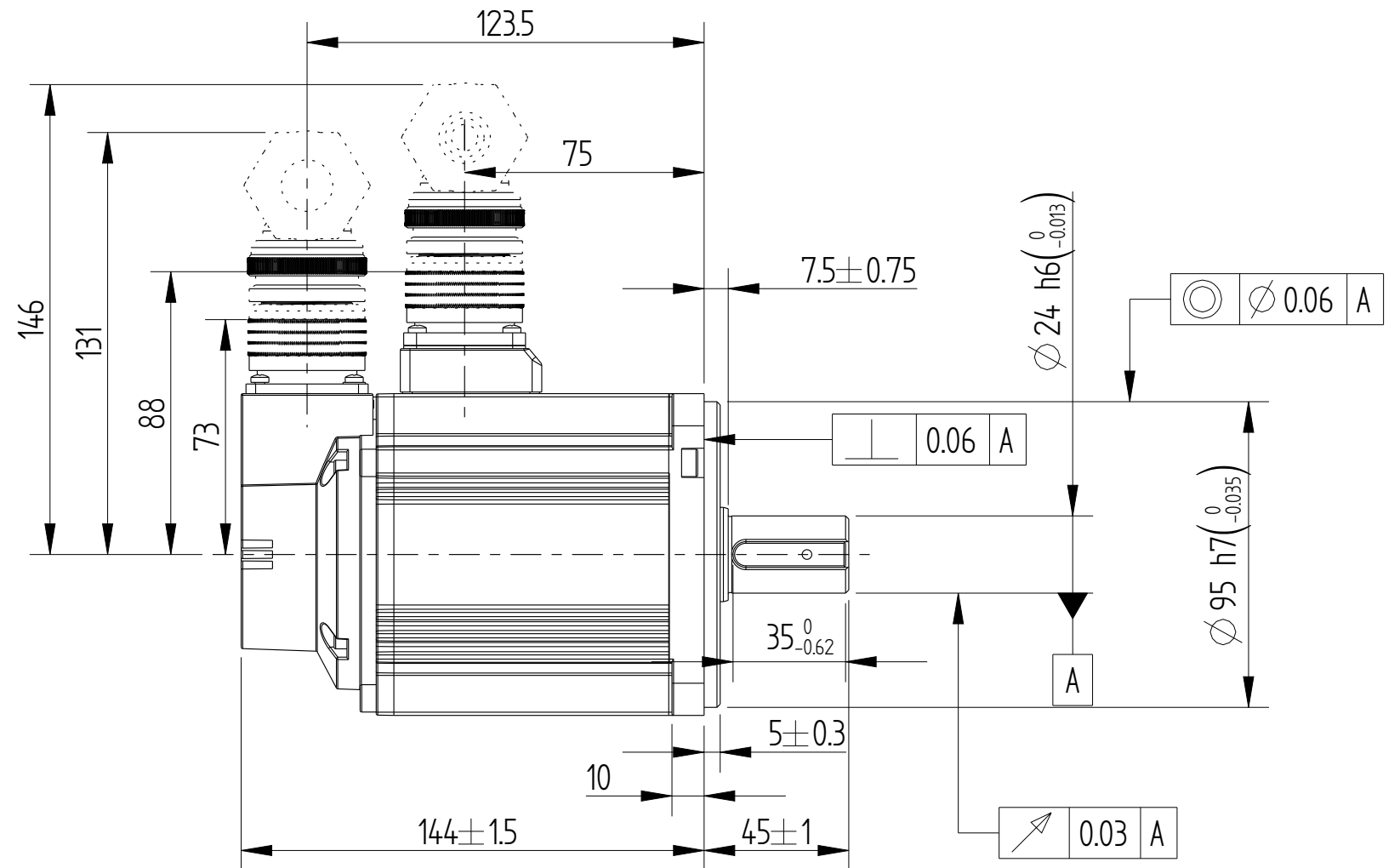
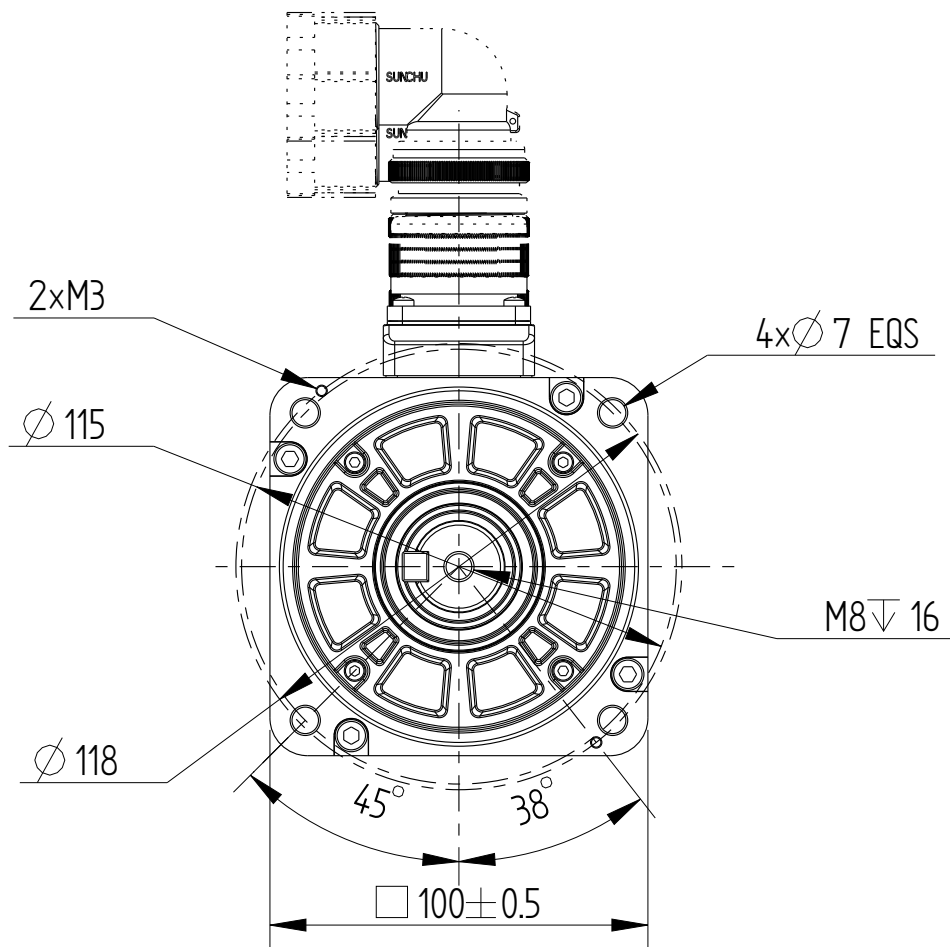

Dimension of shaft end

Dimension of shaft end with key

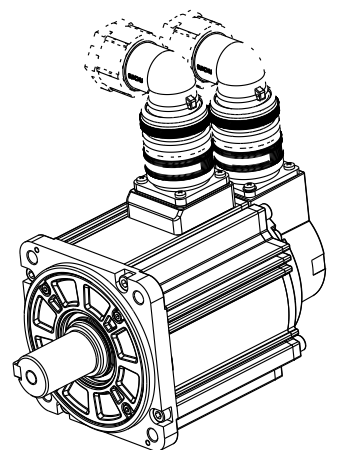

| Basic function parameters | |
|---|-----------------|
| Rated power KW | 1 |
| Rated voltage V | 380 |
| Rated current A | ≤ 3.3 |
| Peak current at rated speed A | ≤ 11 |
| Rated torque Nm | 3.18 |
| Peak torque at rated speed Nm | 9.54 |
| Rated speed rpm | 3000 |
| Max speed rpm | 6000 |
| Rotor inertia $\text{kg} \cdot \text{cm}^2$ | $1.78 \pm 10\%$ |
| Encoder resolution | 23bit |
| Insulation class | F(155° C) |
| Protection level | IP67 |
| Static torque of brake Nm | / |
| Brake power supply | / |
| Duty cycle | S1 |
| Radial line load N | ≤ 686 |
| Axial load N | ≤ 196 |

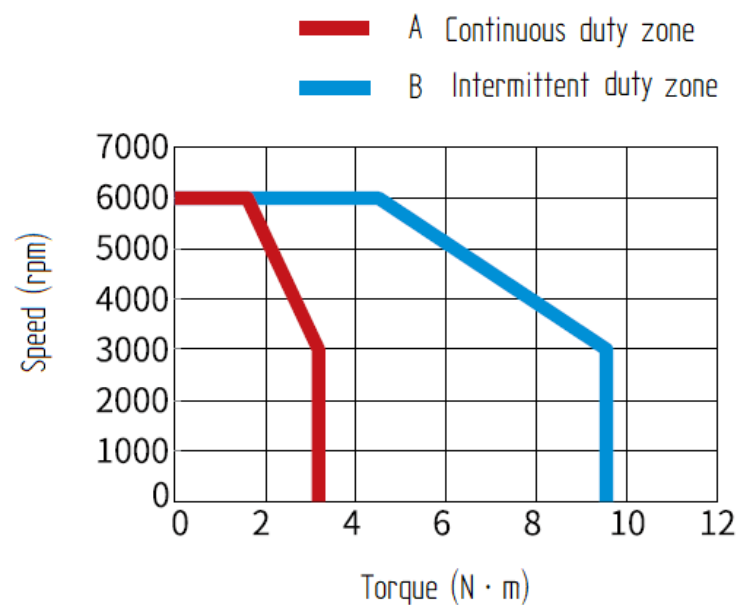

| | | | | | | | | |
|-----------------|---------------|------------|----------|-----------------------|-------|---------|-------------|------------------------|
| | | | | Motor Outline Drawing | | | 01117913-WX | |
| B00 | New Archive | / | 20230912 | | | | | |
| Version | Change method | Changed by | Date | | | | | |
| Design | / | | | / | | | Mark | INOVANCE |
| Check | / | | | | | | | |
| Craft | / | | | | | | | |
| Verify | / | | | Weight | Scale | Version | Page 1 of 1 | |
| Standardization | / | | | 3.85kg | 12 | B00 | Model | MS1H2-10C30□-A331R-INT |
| Approve | / | | | | | | | |